

# WE ENERGIES/WISCONSIN GAS LLC NORTHERN INDUSTRIAL SANDS PROJECT TOWN OF DOVRE, BARRON COUNTY, WI

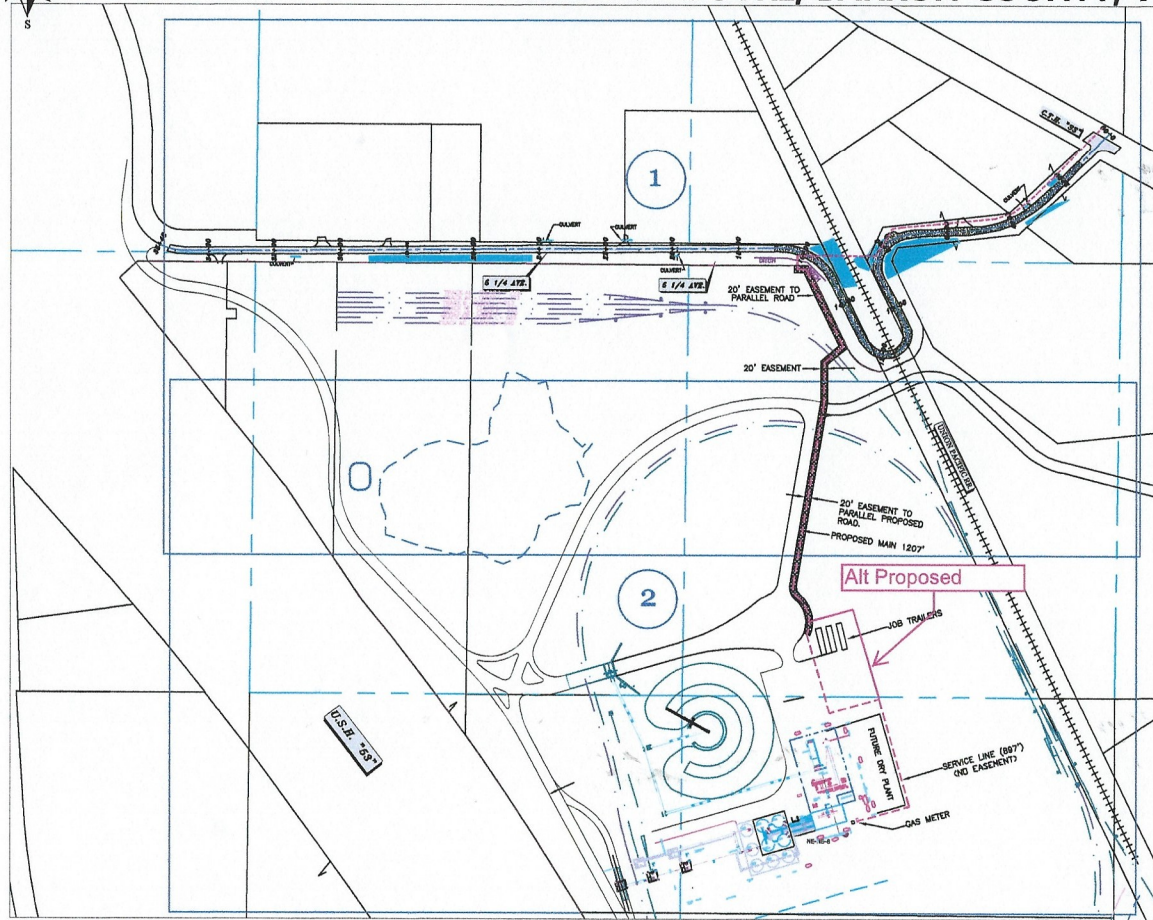

- BASIS OF BEARINGS  
BEARINGS ARE BASED ON THE WISCONSIN COUNTY COORDINATE SYSTEM (BARRON)
- = PARCEL LINE
  - = EXISTING DITCH
  - x - x = EXISTING FENCE
  - - - = SECTION 7' 40' line
  - - - - - = PROPOSED NATURAL GAS LINE
  - - - - - = ROAD CENTERLINE
- 
- = WETLANDS
  - = EXISTING ASPHALT
  - = GRAVEL ROADWAY
  - = 20' PROPOSED PIPELINE EASEMENT

**CUSTOMER SITE PLAN APPROVAL:**

*Larry McGlumphy*  
SIGNATURE  
**LARRY McGlumphy/GM**  
PRINT NAME/TITLE  
**12/10/14**  
DATE